

**Description**

Parthos Slimline & Lightweight Movable Wall System, Non Fire Rated, Acoustic Insulation of 36 - 44 dB Rw. Visible Vertical Seal



**Product Summary**

A slimline and lightweight movable wall system, non fire rated and with high acoustic properties. Lightweight construction makes the system very easy to operate

**Certification**

European Norm	No Harmonised European Norm
Product Classification	n/a (No Harmonised European Norm)
EC Certificate of Conformity No.	n/a (No Harmonised European Norm)
Certifire No.	n/a
Declaration of Performance	n/a (No Harmonised European Norm)
Other Test Evidence	n/a

**BIM Assist™**

**BC(A)R Assist™\***

**Guarantee**

**2 Years**

Last Reviewed

16/08/2019

\* ROI Only

For the purpose of continual product development, KCC reserves the right to change specifications without notice. Please accept all dimensions as approximate. E&OE. © KCC Group 2022.

## Description

Parthos Slimline & Lightweight Movable Wall System, Non Fire Rated, Acoustic Insulation of 36 - 44 dB Rw. Visible Vertical Seal



### Features

- Slimline & lightweight moveable wall system designed to eliminate the need for floor guides
- Reduced space requirement when parked
- Easy to use, due to lightweight construction
- Solid panel, straight wall system
- Non fire rated
- Excellent acoustic properties of 36 to 44 dB Rw
- Extensive design options that include walls that can contain single or double doors
- Available in a broad range of finishes
- Strong aluminium and wood stable and self supporting frame provides heights of up to 3,050mm
- Multiple stacking possibilities

### Technical Characteristics



- Panel Thickness: 80mm
- Panel Height: 1,500mm-3,050mm
- Panel Width: 600-1,240mm
- Frame Construction: Aluminium and wood
- Board Material: 10mm, part of frame construction
- Walls and Ceiling Tracks: Heavy duty, straight
- Floor Track: Not required
- Carrier: Ball bearing trolleys
- Fire Safety: Non fire rated
- Vertical Profiles: Aluminium construction, Black EPDM rubber with double sealing profiles
- Pressure Sleeves: Black aluminium with double sealing profiles
- Operation of Pressure Sleeves: Manual
- Doors: Single or double door, in panel or fixed single door
- Sound Insulation: 36, 40, 42, 44 dB Rw
- Weight: 20-37kg/m<sup>2</sup> (approximate and variable against sound insulation value)

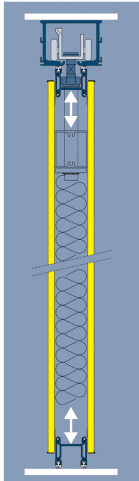

**Sectional View**

- The smooth running ball bearing track system is typically concealed in the ceiling
- The image shows the pressure sleeves at the ceiling and at the floor. Once the wall is deployed and in position, these sleeves are activated manually via a crank handle

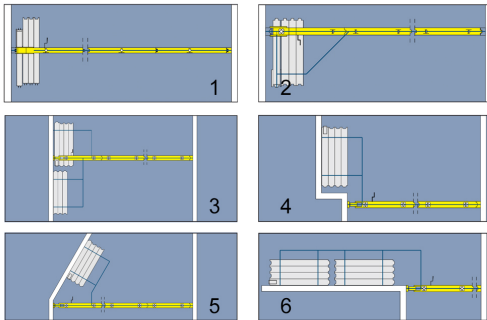

**Popular Parking Options**

- ① One point suspension
- ② One point suspension with forced guidance
- ③ ④ ⑤ ⑥ Two point suspension with cross guidance

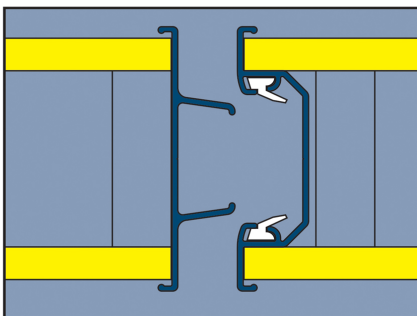

**Cross Sectional View**

- The Palace 80 system has a visible seal as shown



**Installation Examples**

- The cranked handle deploys the ceiling and floor seals



**Installation Examples**

- Palace 80



**Installation Examples**

- Palace 80



**Installation Examples**

- Palace 80 ceiling track

**Description**

Parthos Slimline & Lightweight Movable Wall System, Non Fire Rated, Acoustic Insulation of 36 - 44 dB Rw. Visible Vertical Seal

**Specification Text****MOVEABLE WALL SPECIFICATION**

- Manufacturer: KCC Group / Parthos
- Product reference: KW-PALACE 80/NFR
- Type: Parthos Slimline & Lightweight Movable Wall System
- Fire: Non Fire Rated
- Panel Thickness: 80mm
- Panel Height: 1,500mm-3,050mm
- Panel Width: 600-1,240mm
- Frame Construction: Aluminium and wood
- Board Material: 10mm, part of frame construction
- Walls and Ceiling Tracks: Heavy duty, curved and straight
- Floor Track: Not required
- Carrier: Ball bearing trolleys
- Vertical Profiles: Anodised aluminium with visible seal
- Pressure Sleeves: Aluminium construction, Black EPDM rubber with double sealing profiles
- Operation of Pressure Sleeves: Manual
- Doors: Single or double door, in panel or fixed single door
- Sound Insulation: 36, 40, 42, 44 dB Rw [SPECIFY]
- Finish: [SPECIFY]