

Description

56 Series Surface Mounted Panic Bolt c/w top and bottom locking points

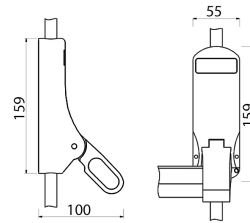

Technical Features

Function & Operation Surface mounted push bar panic bolt for single or double door applications. Depressing the bar provides safe and speedy egress

Summary of Features Surface mounted, non handed, fire rated for use on timber or steel doors

Options Adjustable shoots (suffix A). Steel door fixing specify SD. Microswitch specify MS

Dimensions

Dimensions See drawing

Finishes

Finishes Available Silver, White or Black, Stainless Steel or Brass Effect

Certification

European Norm hEN1125:2008

Product Classification ③⑦⑥B①③②②A A

EC Certificate of Conformity No. See DOP

Certifire No. CF5257

Declaration of Performance DOP201

Other Test Evidence n/a

BIM Assist™

CE

Certifire

BC(A)R Assist™*

Guarantee

10 Years

Last Reviewed

02/03/2017

* ROI Only

For the purpose of continual product development, KCC reserves the right to change specifications without notice. Please accept all dimensions as approximate. E&OE. © KCC Group 2020.

Description

56 Series Surface Mounted Panic Bolt c/w top and bottom locking points



Specification Text

571 EMERGENCY EXIT DEVICES

- Standard: To BS EN 1125.
- Emergency exit devices for locked doors on escape routes: CE marked.

- Manufacturer: KCC Group
- Product reference: KE-5620
- Type: 56 Series Surface Mounted Panic Bolt
- Material/ finish:[SPECIFY FINISH]

· Additional requirements: Certifire Approved, 10 Year Warranty

572 PERFORMANCE SPECIFICATION FOR EMERGENCY EXIT DEVICES

- Standard: To BS EN 1125.
- Emergency exit devices for locked doors on escape routes: CE marked.

- Minimum classification grades:
- Category of use: 3
- Durability: 7
- Door mass: 6
- Suitability for use on fire/ smoke doors: B
- Safety: 1
- Corrosion resistance: 3
- Security: 2
- Projection of operating element: 2
- Type of operation: A
- Type of operation: A
- Material/ finish: [SPECIFY FINISH]

